



## Geith International Ltd.

Block B, Swords Business Campus,  
Swords, Co. Dublin,  
Ireland.  
Tel: ++ 353 (0)1 6502100.

### *Statement of Compliance*

We hereby state that the Geith Double Locking Excavator Quick Hitch Gen 3 is compliant with NSW Position Paper– June 2015 – “Supplying, Installing and using Quick hitches on Excavators or Backhoe Loaders.” This compliance statement also covers Tilting Hitches where the hitch unit is the Geith Gen 3 type Quick Hitch model.

**Serial#: 1156135**

**SBA Description: QC60H6G3**

This document is associated to and must be read in conjunction with the Geith Double Acting Quick Hitch Operators Instruction Manual that is supplied with the Quick hitch

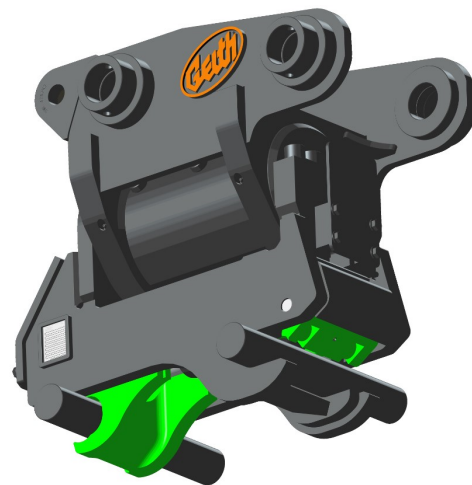

Name: Tony McKeown

Position: Engineering Manager

Signature:.....

Date: 13/8/19

Being the responsible person appointed by the manufacturer

Drawing Document number: 823-112126