



Geith International Ltd.
 Block B, Swords Business Campus,
 Swords, Co. Dublin,
 Ireland.
 Tel: ++ 353 (0)1 6502100.

Statement of Compliance

We hereby state that the Geith Double Locking Excavator Quick Hitch Gen 3 is compliant with NSW Position Paper– June 2015 – “Supplying, Installing and using Quick hitches on Excavators or Backhoe Loaders.” This compliance statement also covers Tilting Hitches where the hitch unit is the Geith Gen 3 type Quick Hitch model.

Serial#: 1004006
SBA Description: QC90H1G3

This document is associated to and must be read in conjunction with the Geith Double Acting Quick Hitch Operators Instruction Manual that is supplied with the Quick hitch

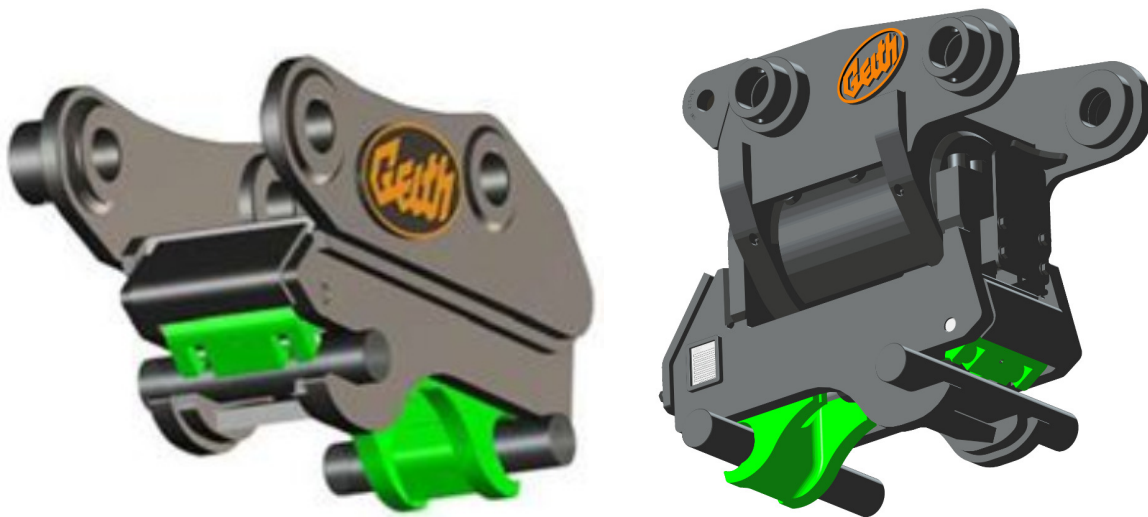

Name: Tony McKeown

Position: Engineering Manager

Signature:.....

Date: 13/8/19

Being the responsible person appointed by the manufacturer

Drawing Document number: 823-112126